



HOUSE & LAND PACKAGE

18 TEIHANA ROAD, TE PUNA, WESTERN BAY OF PLENTY

\$1,999,598*

COUNTRY DREAM LIVING

4  2  2  1 

Don't just build a house—build a landmark. A stunning home with breathtaking views awaits you in the beautiful gated community of Teihana Te Puna. This prime section offers a serene, countryside feel while keeping you close to all essential amenities. Enjoy the perfect blend of privacy, security, and stunning surroundings!

The Cromwell Ready to Build plan exudes a charming country feel, beautifully complementing the site. Its timeless weatherboard cladding adds to the home's aesthetic appeal. With four bedrooms and a study, this classic family residence is designed for comfort. The open-plan living area, complete with bi-folding doors, seamlessly connects to the veranda for effortless indoor-outdoor flow.

The central kitchen boasts a spacious pantry and high-quality appliances, perfect for culinary enthusiasts.

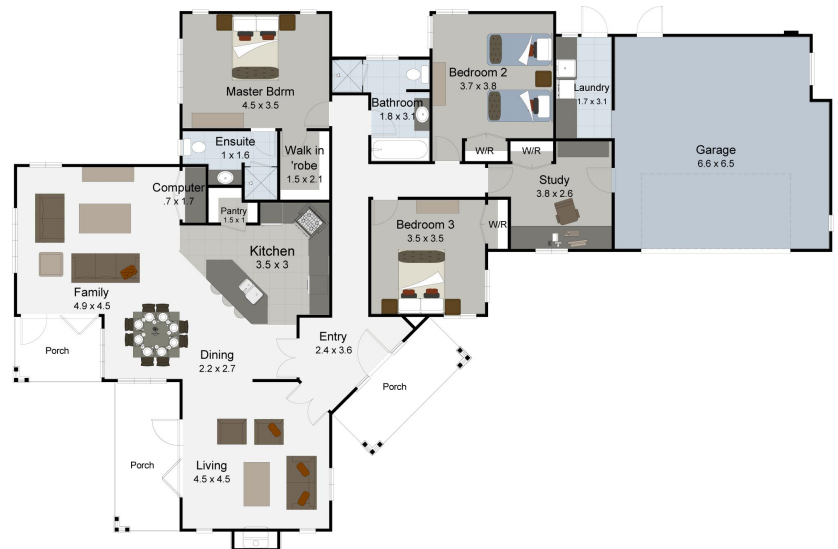

SPECIAL FEATURES

- Open plan living with central kitchen
- Walk-in Pantry
- Wide verandah to entry and living areas
- Traditional exterior detailing and weatherboard cladding



DIMENSIONS

Total Living Area	177.1m ²
Garage Area	44m ²
Total Floor Area	221.1m ²
Porches	21.7m ²
Total Area	242.8m ²
Land Area	2405m ²



*NB: These images are an indication of what can be built on the site for the package price. Negotiation and purchase of this House & Land package will be directly through Landmark Homes Bay of Plenty.

CONTACT SHANE RAYMOND
027 570 0908
shane.raymond@landmarkhomes.co.nz

